

This information has been based upon information supplied by third parties and as such its accuracy cannot be guaranteed. All features are approximate and subject to clarification.

Do not scale this drawing. Use figured dimensions in all cases. Check all dimensions on site. Report any discrepancies to GT3 Architects before proceeding.

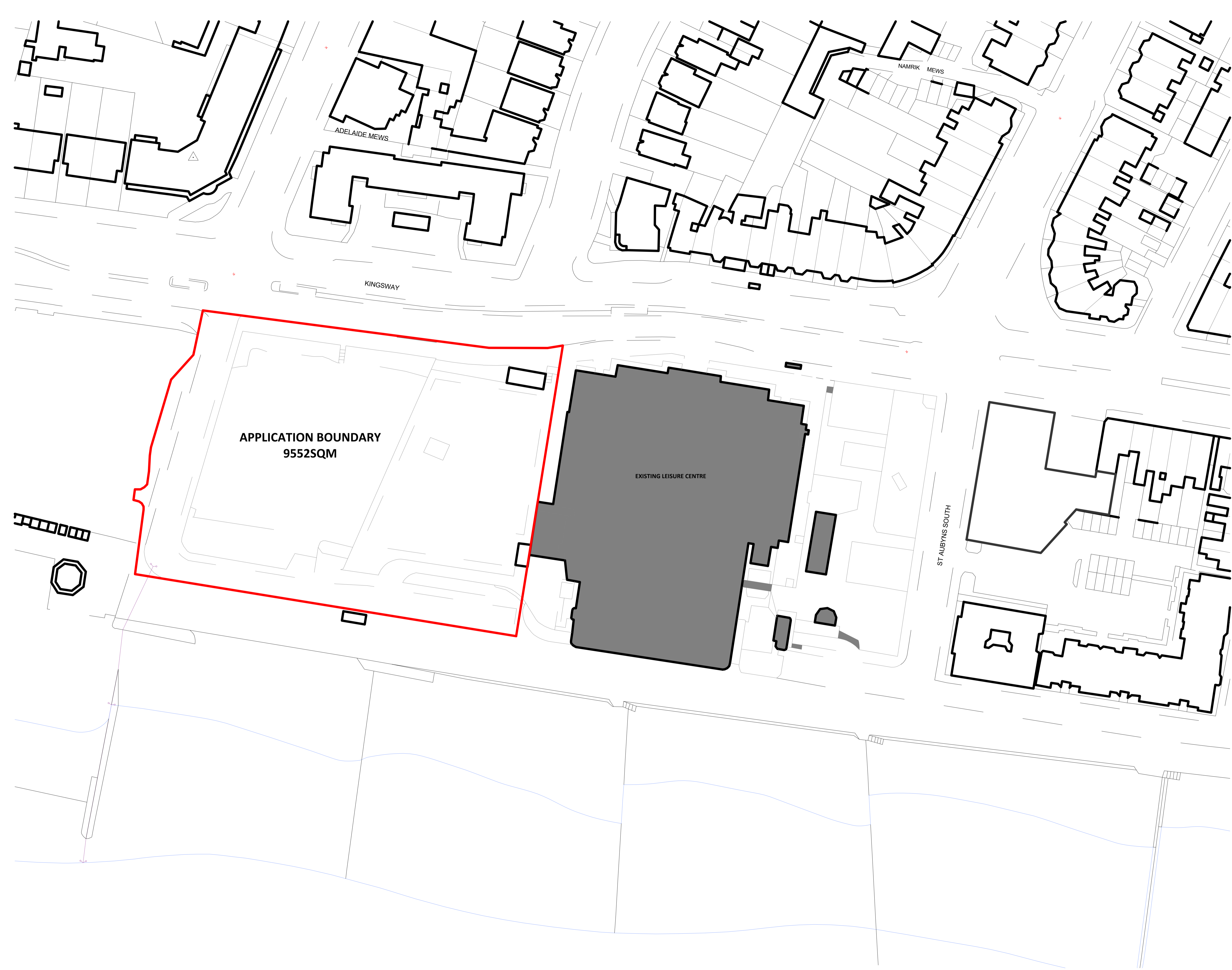

Rev.	Description	Issued	Checked	Date
------	-------------	--------	---------	------

Brighton & Hove City Council				
King Alfred Leisure Centre				

Hove Town Hall,
Norton Rd,
Brighton and Hove,
Hove
BN3 3BQ

Existing Site Plan

GT3 PROJECT NO: 24051
DWG NO: 24051 - GT3 - 00 - XX - DR - A - 08-0901 -
SCALE: 1:500
SHEET SIZE: A1
DRAWING STATUS: Preliminary

Newcastle
0191 2817700

Nottingham
0115 9470800

www.gt3architects.com
info@gt3architects.com

